

Installation schemes

Baxi Mago + GTW16 (Modulating OpenTherm or On/Off)

- 1) Adapter kit connection (OpenTherm or On/Off *)
- 2) Adapter kit (GTW16) with 24V transformer
- 3) Baxi Mago connection (R-Bus; 2 wires, possibly shielded cables)
- 4) Domestic wi-fi connection to the Router
- 5) Connection with App Baxi Mago

* to locate OpenTherm terminal in the boiler, see boiler technical guide

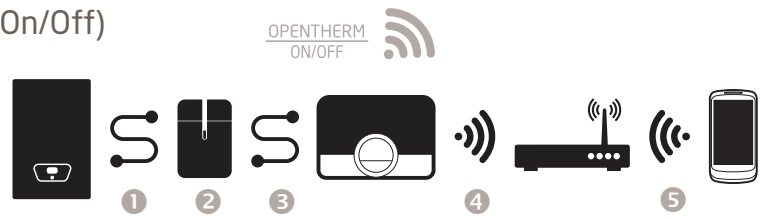

Baxi Mago

- 1) Baxi Mago connection (R-Bus; 2 wires, possibly shielded cables)
- 2) Domestic wi-fi connection to the Router
- 3) Connection with App Baxi Mago

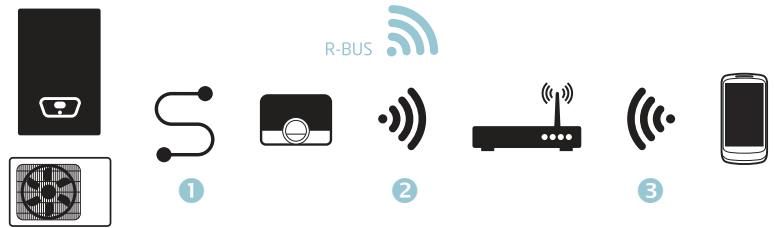

Packages

Baxi Mago + GTW16 for products with OpenTherm protocol

1) Baxi Mago package:

- Baxi Mago
- Screw and plug fixings
- Mounting bracket for wall hung installation
- User guide

2) Gateway package:

- Adapter kit or Gateway (GTW)
- Power adapter, exposed wires to be connected inside the boiler
- Screw and plug fixings
- Installation guide

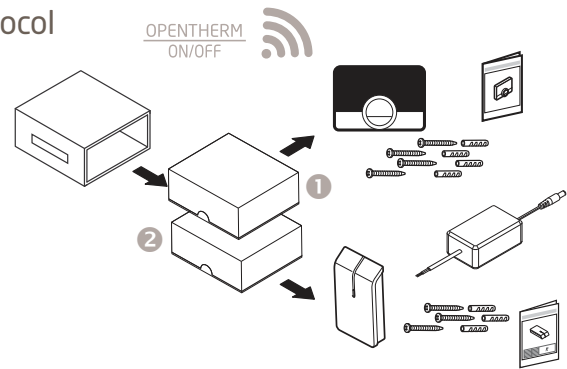

Baxi Mago for products with R-BUS protocol

1) Baxi Mago package:

- Baxi Mago
- Screw and plug fixings
- Mounting bracket for wall hung installation
- User guide

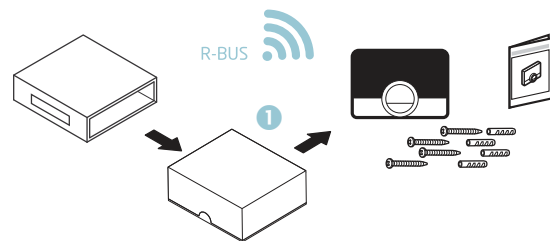

Technical data

Dimensions	
Width x height x depth (Baxi Mago)	120 x 90 x 27 mm
Width x height x depth (Gateway) - only for Baxi Mago with OpenTherm or ON/OFF protocol	84 x 145 x 29 mm
Electrical power supply	
Bus connection voltage	24 V ± 5%
Maximum electrical consumption	1,5 W
Electrical connection	
Maximum cable length for dedicated Baxi Mago bus	50 m
Maximum cable resistance	2 x 5 ohm
Ambient conditions	
Operating conditions	from 0 °C to 60 °C
Temperature	
Measurable room temperature range	from 5 °C to 60 °C
Maximum temperature deviation at 20°C	0,3 °C
Maximum room control overshoot after pre-heating	1 °C
Temperature variation	+/- 0,5 °C
Temperature control range	from 10 °C to 30 °C